

LIVING

OLIVIERI



OLIVIERI

INDEX

Azienda <i>Company</i>	4
Dress Code	18
Concept	20
Inspiration	36
Living	50
Porte d'arredo <i>Doors</i>	148
Cube 6	182
Complementi giorno <i>Day complements</i>	216
Movida	218
Cosmo	228
Aqua	240
Madia Dress Code	250
Tavolo Mr. Big	260
Tavolo Hector	268
Tavolo Ambrogio	274
Sedia Adam	280

**Ogni nuova collezione
è un nuovo inizio,
ogni nuovo progetto
una nuova sfida.
Ed è così dal 1929.**

Every new collection is a new beginning,
every new project a new challenge.
And it's been that way since 1929.





La grande falegnameria industrializzata

IT

Olivieri opera nel settore dell'arredamento da 95 anni e viene identificata oggi come una grande falegnameria industrializzata che produce principalmente boiserie contenitive e boiserie a parete, lavorando su misura al millimetro a tutt'altezza e a tutta larghezza ed integrando anche porte d'arredo. Per noi anche un armadio è una boiserie contenitiva a tutt'altezza.

La lunga esperienza nel segmento delle armadiature ci ha permesso di mettere a punto un sistema produttivo capace di coniugare qualità di prodotto e competitività.

Siamo una delle pochissime aziende italiane che realizza il proprio sistema contenitivo in tamburato (struttura e ante) fornendo così ai nostri prodotti maggiore durevolezza nel tempo e resistenza al carico; ma anche minor peso che significa minor carico sulla ferramenta e notevoli vantaggi su trasporto e montaggio.

The big industrialized carpentry

EN

Olivieri is a company that has been operating in the furniture market for 95 years, and is identified as a big industrialized carpentry that mainly produces storage boiserie and wall cladding, fully customized in total height and total width, also integrating decorative doors. For us, even a wardrobe is a full-height storage boiserie.

The long experience with the cabinets allowed us to define a production system capable of combining quality and competitiveness.

We are one of the few Italian companies which produces its storage system in honeycomb (structure and doors), providing our products with greater endurance and loading resistance, but also lighter weight, which means less load on the hardware and big advantages on transport and installation.

L'impostazione industriale delle nostre linee produttive prevede la convivenza di fasi ad alta automazione insieme a lavorazioni speciali da parte di maestranze specializzate nel reparto falegnameria.

Questo ci permette di gestire in modo industriale lavorazioni artigianali e materiali personalizzati.

The industrial approach of our production lines includes the combination of highly automated phases alongside specialized craftsmanship in the woodworking department.

This allows us to manage special processes and customized material in an industrial manner.







Nel mondo dell'arredamento esiste ormai una netta distinzione tra chi produce e vende prodotti e chi è orientato al "su misura".

Olivieri ha scelto di dedicarsi al mondo del progetto, potendo rappresentare per i propri clienti un unico interlocutore capace di offrire grande flessibilità in tempi e metodi industriali.

In the furniture market, there is now a clear distinction between those who produce and sell products and those who are oriented in the custom made projects.

Olivieri dedicates itself to the world of design projects, being able to represent a unique company for its clients, capable of offering great flexibility in terms of time and industrial methods.



DRESS CODE

**Sistema di boiserie
contenitive e a parete
con integrazione
di porte d'arredo**

Storage and wall boiserie system
with integration of furnishing doors

Concept

Dress Code: il sistema pensato sul progetto

Dress Code: the system designed for the projects

IT

Dress Code è la rappresentazione della nostra identità e delle nostre caratteristiche aziendali: CODE è il codice tecnico, la componente industriale; DRESS è la falegnameria, il vestito sartoriale, il su misura, la decorazione e le personalizzazioni nella sua forma e nella sua estetica.

Contenimento

Boiserie a parete e contenitive

Blocchi

Integrazione Cube 6

Accessori

Porte d'arredo

EN

The Dress Code represents our identity and our company characteristics: CODE is the technical code, the industrial component. DRESS is the carpentry, the tailored clothing, the custom-made, the decoration and customizations in its form and aesthetic.

Storage

Wall cladding and storage

Blocks

Cube 6 integration

Accessories

Doors



Contenimento

Storage



A tutta altezza

Total height



Sospeso

Floating



Integrazione Cube 6

Cube 6 integration

IT

Dalla soluzione a tutta altezza, dove le superfici verticali si sostituiscono esteticamente alla parete delineando gli spazi senza interruzione, al contenimento sospeso che agisce per sottrazione creando equilibri tra pieni e vuoti, fino all'integrazione con i volumi modulari del sistema Cube6, Dress Code si presenta in 3 principali varianti.

EN

By the total height solution where vertical doors aesthetically replace the walls, delineating spaces without interruption, to the floating storage that acts through subtraction, creating a balance between solids and voids, and finally integrating with the modular system of the Cube6, Dress Code is available in three main options.



Blocchi

Blocks



Blocco TV
TV block



Blocco TV e nicchia giorno
TV block and niche



Blocco Bar
Bar block



Camino a vapore
Vapor fireplace



Camino 3D
3D fireplace



Box Arte
Art box



Integrazione Cube 6

Cube 6 integration



Cube 6 + contenimento su 1 lato

Cube 6 + 1 side storage



Cube 6 + contenimento su 2 lati

Cube 6 + both sides storages



Mensolone H 12 cm

Shelf H 12 cm



Mensola vaschetta H 12 cm

Hanging tray H 12 cm



Boiserie a parete

Wall cladding



A muro p. 0,8 cm

Wall fixing at 0,8 mm



A muro distanziata p. 6,8 cm

At 6,8 cm distance from the wall



Boiserie contenitiva

Storage



Con contenimento p. 38 cm

With storage d. 38 cm



Con contenimento p. 59,2 cm

With storage d. 59,2 cm



Porte d'arredo

Doors



Porte battenti

Swing doors



Porte scorrevoli

Sliding doors



Pivot

Pivot



Passaggi porta

Folding doors



Accessori

Accessories



Modulo Slim

Slim module



Modulo Bar

Bar module



Mensole sp. 5 cm

5 cm thick shelves



Modulo specchio

Mirror terminal



Modulo appenderia

Hanger terminal



Terminale a giorno

Open terminal



**Tre linee ispirative
interpretano tre differenti
aree di gusto**

Three inspirational styles
create three different moods

Inspiration



Inspiration 1

Classy gentleman



Stile rigoroso, luci soffuse e cura del dettaglio sono le principali caratteristiche del Gentleman.

Rigorous style, soft lighting and attention to details are the main characteristics of the Gentleman.

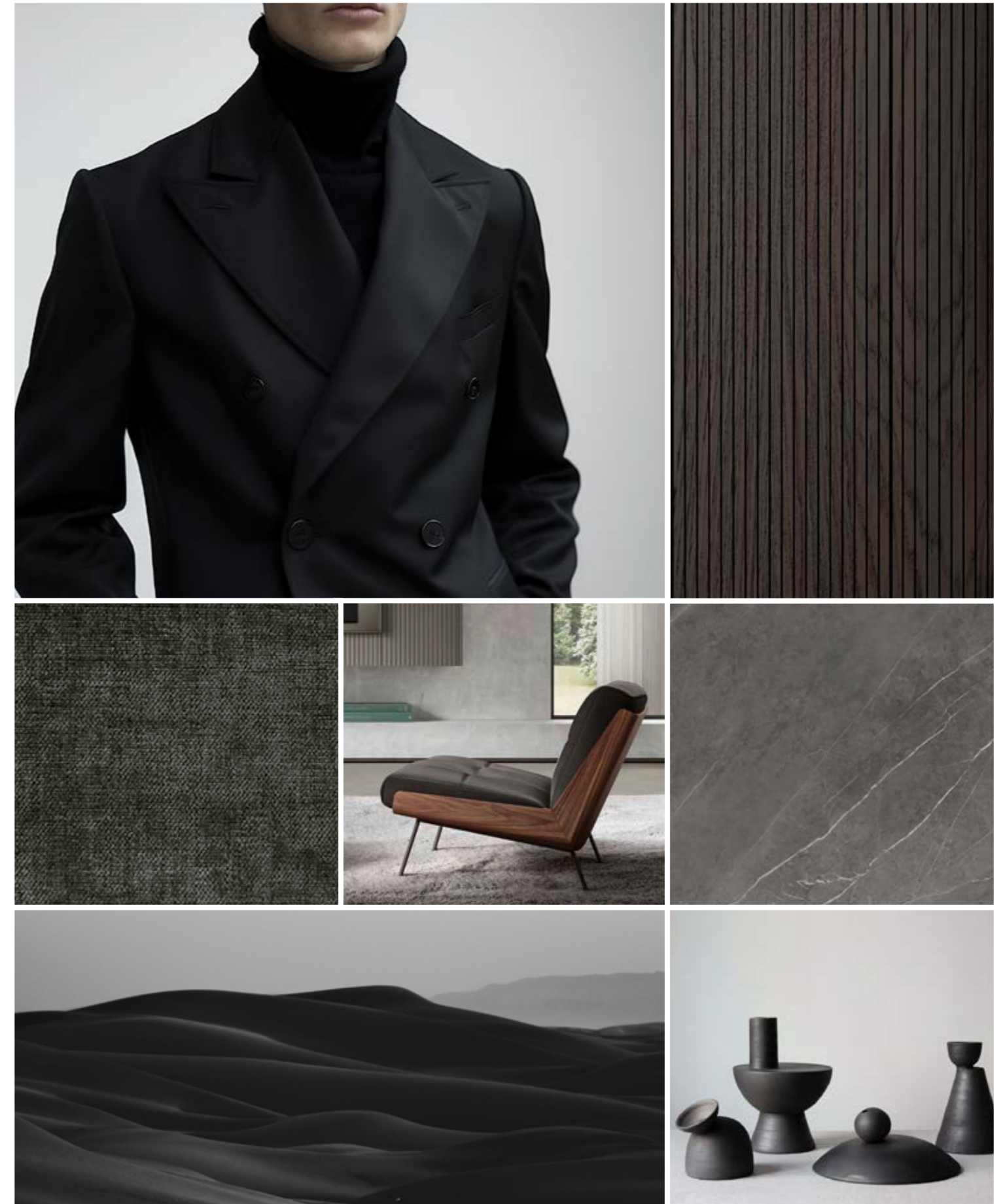



Inspiration 2

Warm family

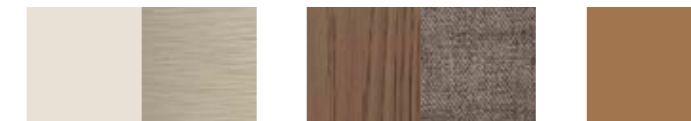

Stile classico, clima familiare e toni caldi sono le principali caratteristiche di questo stile borghese.

Classic style, family atmosphere and warm tones are the main characteristics of this bourgeois style.



Rovere Tabacco . Moka . Tammis 10:10 | Laccato Canapa . Cuoio | Metallico Champagne | Sand Ivory





Inspiration 3

Cozy romantic



Femminilità e illuminazione naturale sono le caratteristiche principali di questo stile romantico.

Femininity and natural lighting are the main features of this romantic style.

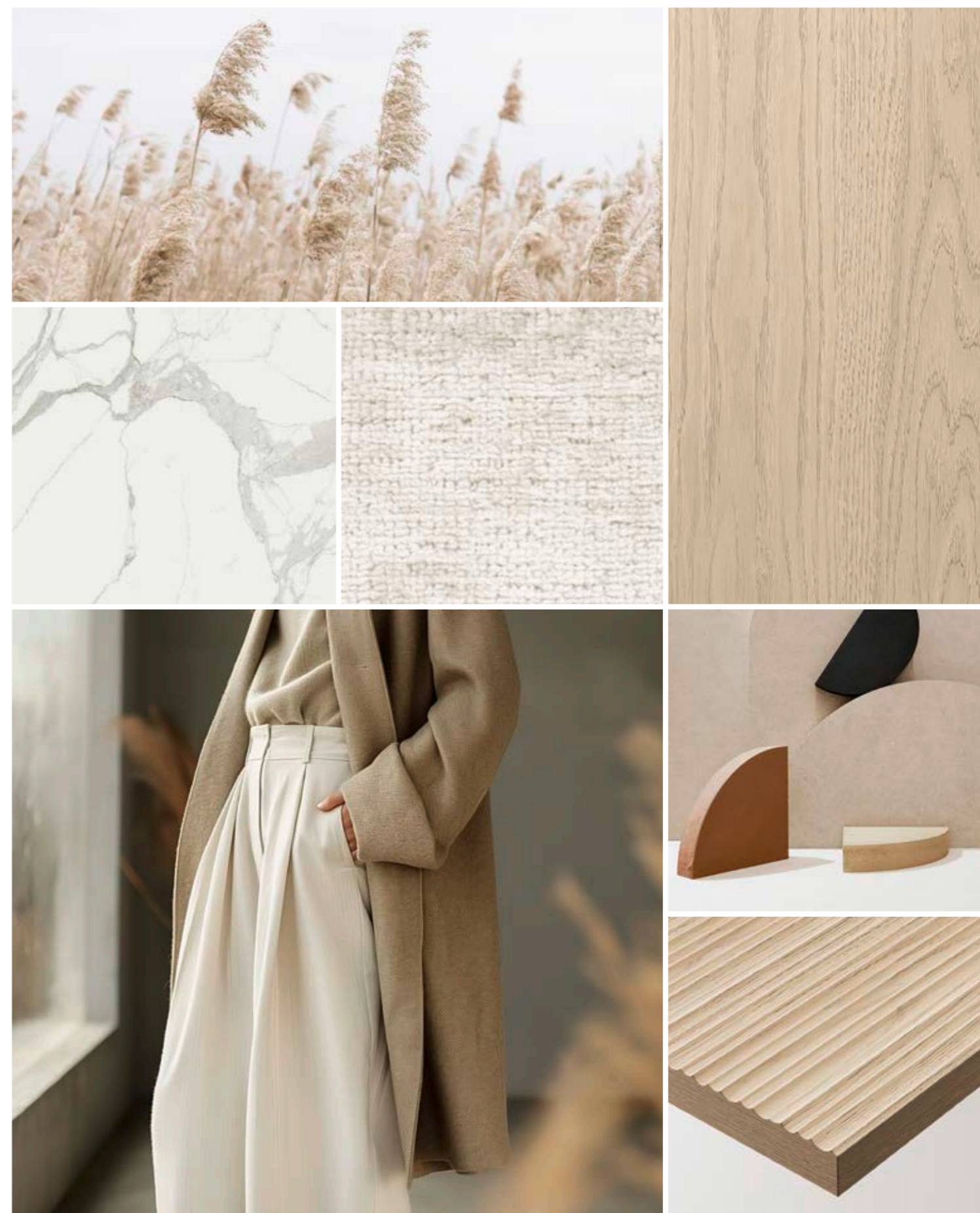

Living

Index



DC 001 54



DC 002 66



DC 007 112



DC 008 118



DC 003 78



DC 004 84



DC 009 122



DC 010 132



DC 005 96



DC 006 106



DC 011 142



DC 001



Classy gentleman

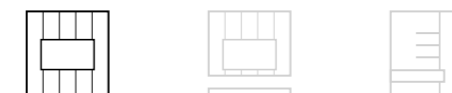

Ante, boiserie e porte in **Rovere Carbon 10:2**. Box TV, nicchia, box bar in **laccato metallico Bronzo**.
Tavolo Mr Big e sedie Adam **Rovere Carbon**. Madia Aqua Bar **laccato opaco Amarone** con base **laccato metallico Bronzo**.

Doors, boiseries and decorative doors in **Carbon Oak 10:2**. TV box, niche, box bar in **Bronze metallic lacquer**.
Mr Big table and Adam chairs in **Carbon Oak**. Aqua Bar sideboard in **Amarone matt lacquer** with **Bronze metallic lacquered** basement.



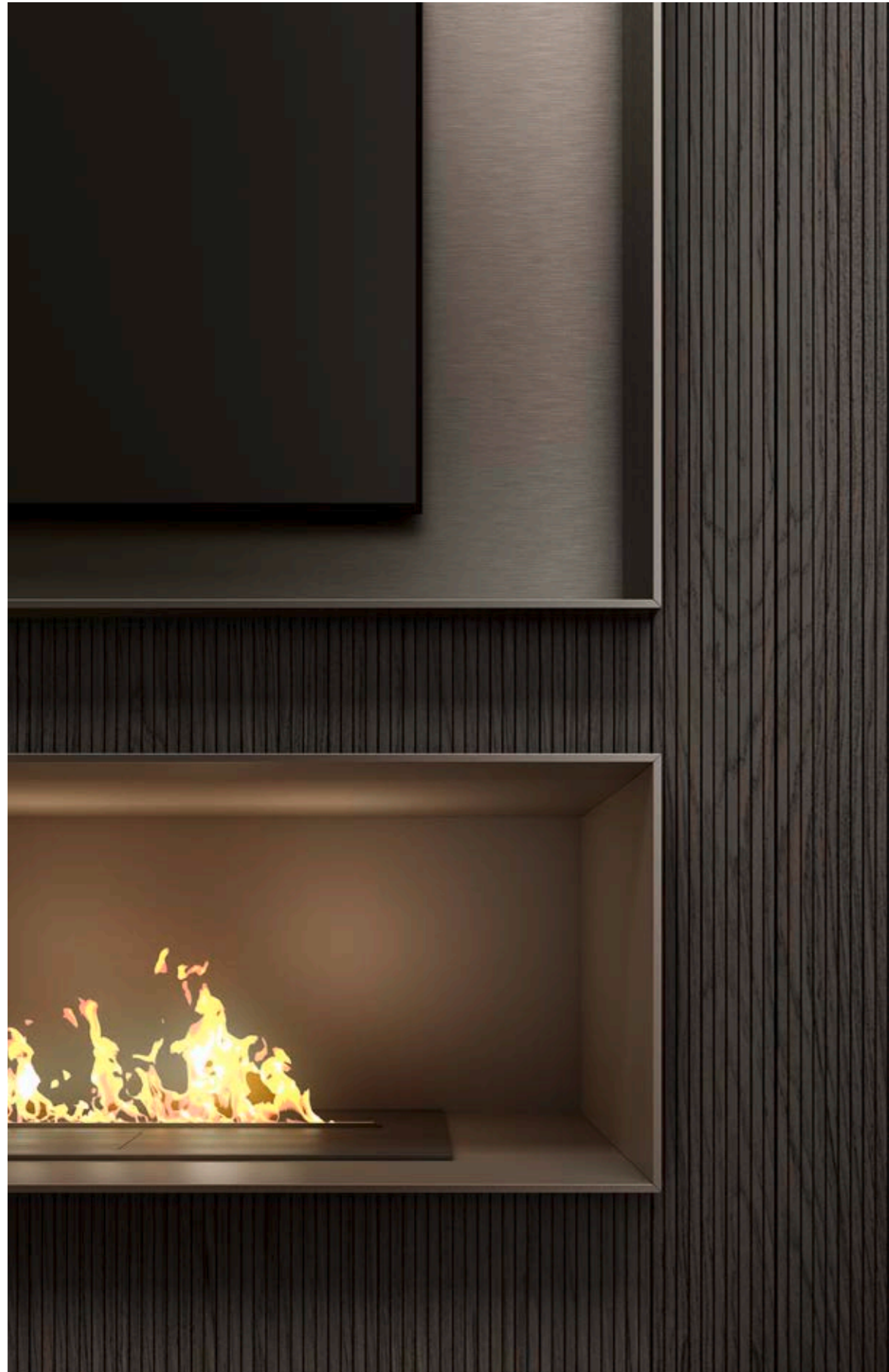









DC 002



Warm family



Ante in **laccato opaco Canapa 2:2**. Box TV, modulo Slim, boiserie e porta in **Rovere Tabacco**.
Madie Cosmo Bar **laccato lucido Cuio**. Tavolo Hector in **Rovere Tabacco** con top in gres **Sand Ivory**.

Doors in **2:2 Canapa matt lacquer**. TV box, Slim module, boiserie and door in **Tobacco Oak**.
Cosmo Bar sideboard **Cuio glossy lacquered**. Hector table in **Tobacco Oak** with **Sand Ivory** stoneware top.



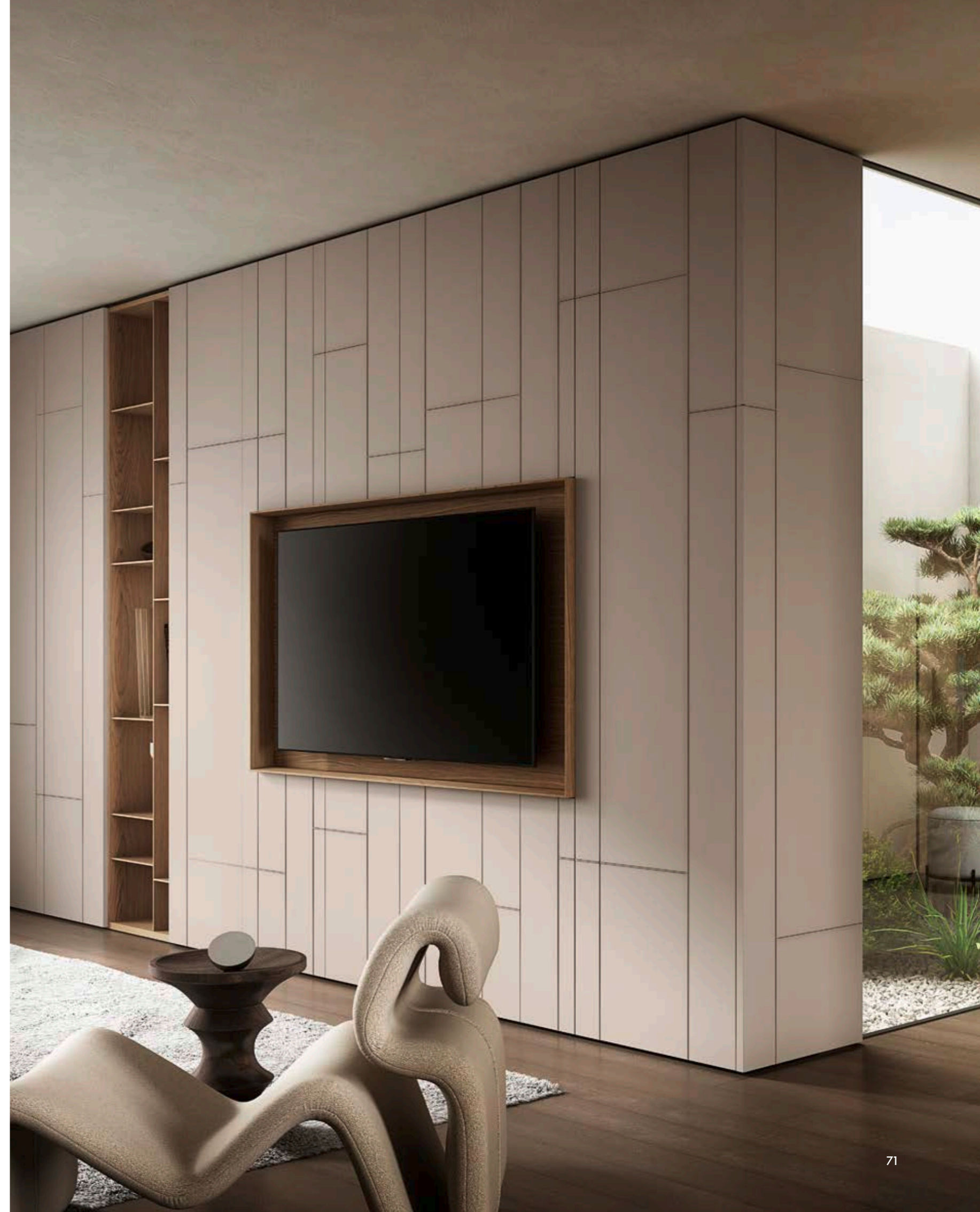









DC 003



Classy gentleman

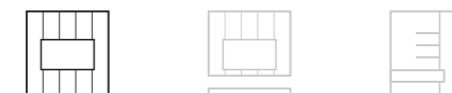

Dress Code in **laccato opaco Antracite 80:40**. Box TV, mensole, in **Rovere Moka**. Camino 3D integrato.

Dress Code in **Antracite matt lacquer 80:40**. TV box, shelves, in **Moka Oak**. Built-in 3D fireplace.







DC 004



Warm family

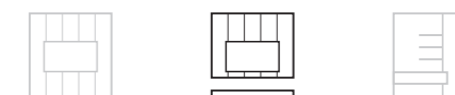

Dress code sospeso in **Rovere Moka**. Box TV **laccato metallico Champagne**. Modulo Slim in **laccato opaco Cuio**.
Floating Dress code in **Moka Oak**. TV box **Champagne metallic lacquered**. Slim library **Cuio matt lacquered**.











DC 005



Cozy romantic

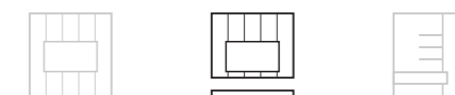

Dress Code in **laccato Lino 10:10** e Cube6 in **laccato Lino**. Boiserie **Rovere Light**. Camino a vapore integrato al Cube6.

Dress Code in **Lino matt lacquer 10:10**. Cube6 in **Lino matt lacquer**. **Light Oak** boiserie. Steam fireplace integrated with the Cube6.









DC 006



Classy gentleman

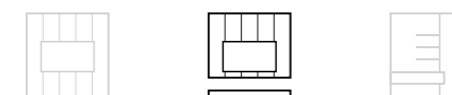

Dress Code sospeso in laccato opaco Titanio 10:10. Box in laccato metallico Bronzo.

Floating Dress Code in Titanio matt lacquer 10:10. Box in Bronze metallic lacquer.







DC 007



Warm family

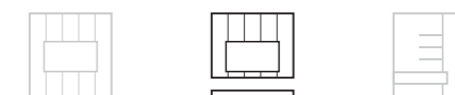

Dress Code sospeso in **laccato opaco Fango**. Box in **laccato metallico Bronzo**. Ante in vetro **trasparente**. Boiserie in **Rovere Tabacco 10:2**.

Floating Dress Code in **Fango matt lacquer**. Box in **Bronze metallic lacquer**. **Transparent glass doors**. Boiserie in **Tabacco Oak 10:2**.







DC 008



Cozy romantic

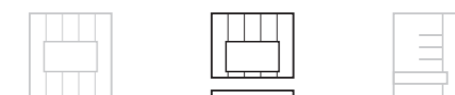

Dress Code sospeso in **laccato opaco Lino**. Box in **laccato metallico Champagne**.
Modulo slim e pedana in **Rovere Light**. Boiserie in **laccato Lino 10:10**.

Floating Dress Code in **Lino matt lacquer**. Box in **Champagne metallic lacquer**.
Slim module and footpad in **Light Oak**. Boiserie in **10:10 Lino matt lacquered**.





DC 009



Classy gentleman



Dress Code in **laccato opaco Titanio 10:10**. Cubeó in **Rovere Carbon**. Boiserie in gres **Pietra Grey**.
Dress code con nicchia orizzontale in **Rovere Carbon Tammas 10:10** e nicchia in **laccato metallico Bronzo**.

Dress Code in **Titanio matt lacquer 10:10**. Cubeó in **Carbon Oak**. Boiserie in **Pietra Grey stoneware**.
Dress code with horizontal niche in **Carbon Tammas Oak 10:10** and niche in **Bronze metallic lacquer**.











DC 010



Cozy romantic



Dress Code e Cube6 in **laccato opaco Lino**. Boiserie in **Rovere Light Tammass Wave**. Madia Dress Code e moduli Slim in **Rovere Light**.
Dress Code and Cube6 in **Lino matt lacquered**. Boiserie in **Light Oak Tammass Wave**. Dress Code sideboard and Slim modules in **Light Oak**.



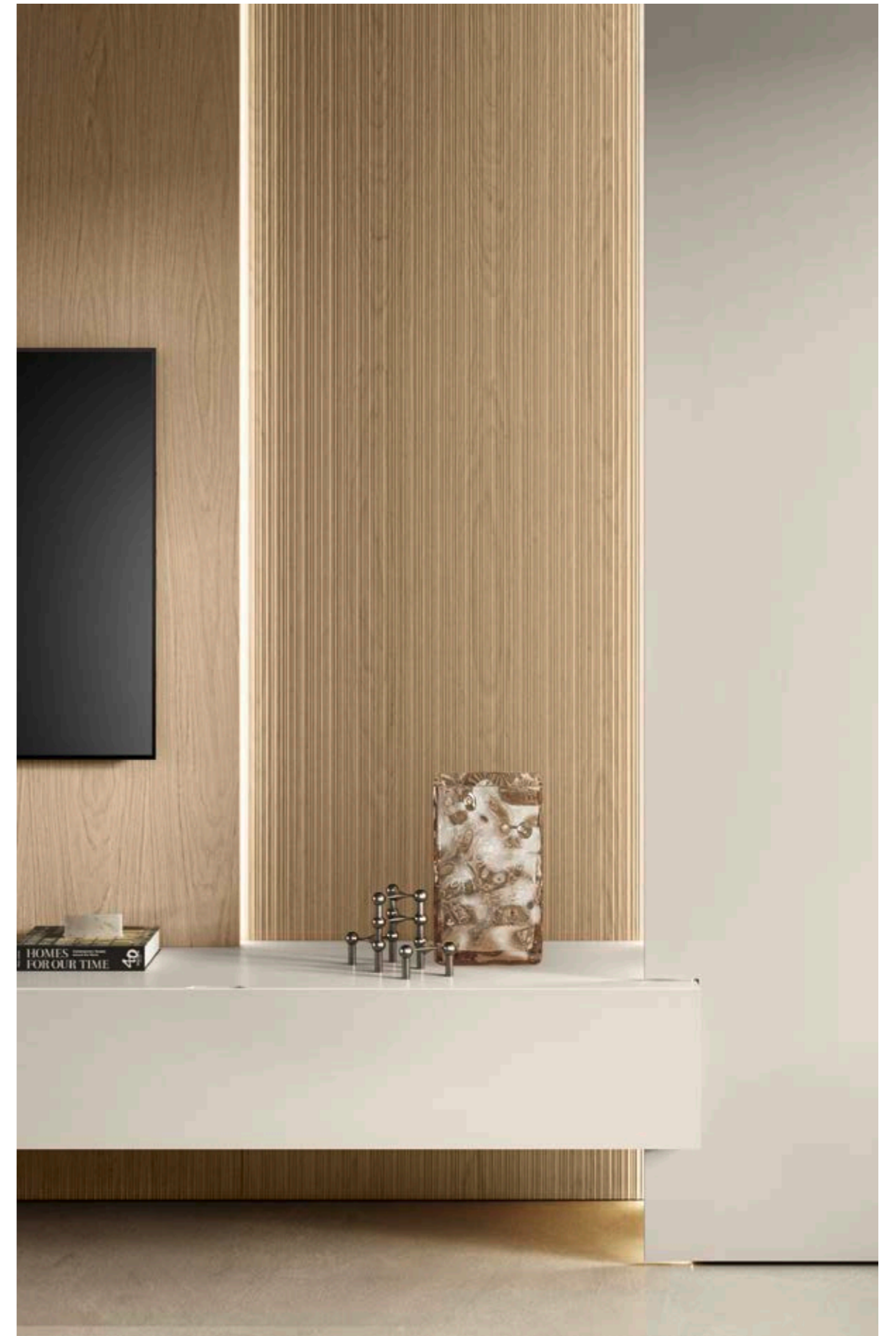







DC 011



Classy gentleman

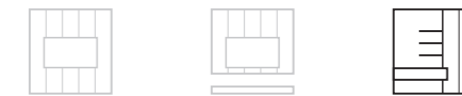

Dress Code in **laccato opaco Antracite Line**. Mensole e mensola vaschetta in **Rovere Grigio**. Boiserie in gres **Pietra Grey**.

Dress Code in **Antracite lacquer Decor-Line**. Shelves and tray shelf in **Grey Oak**. Boiserie in **Pietra Grey** stoneware.





Porte d'arredo

Furnishing doors



Pivot













Battente

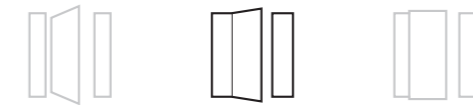

Doors — Swing doors







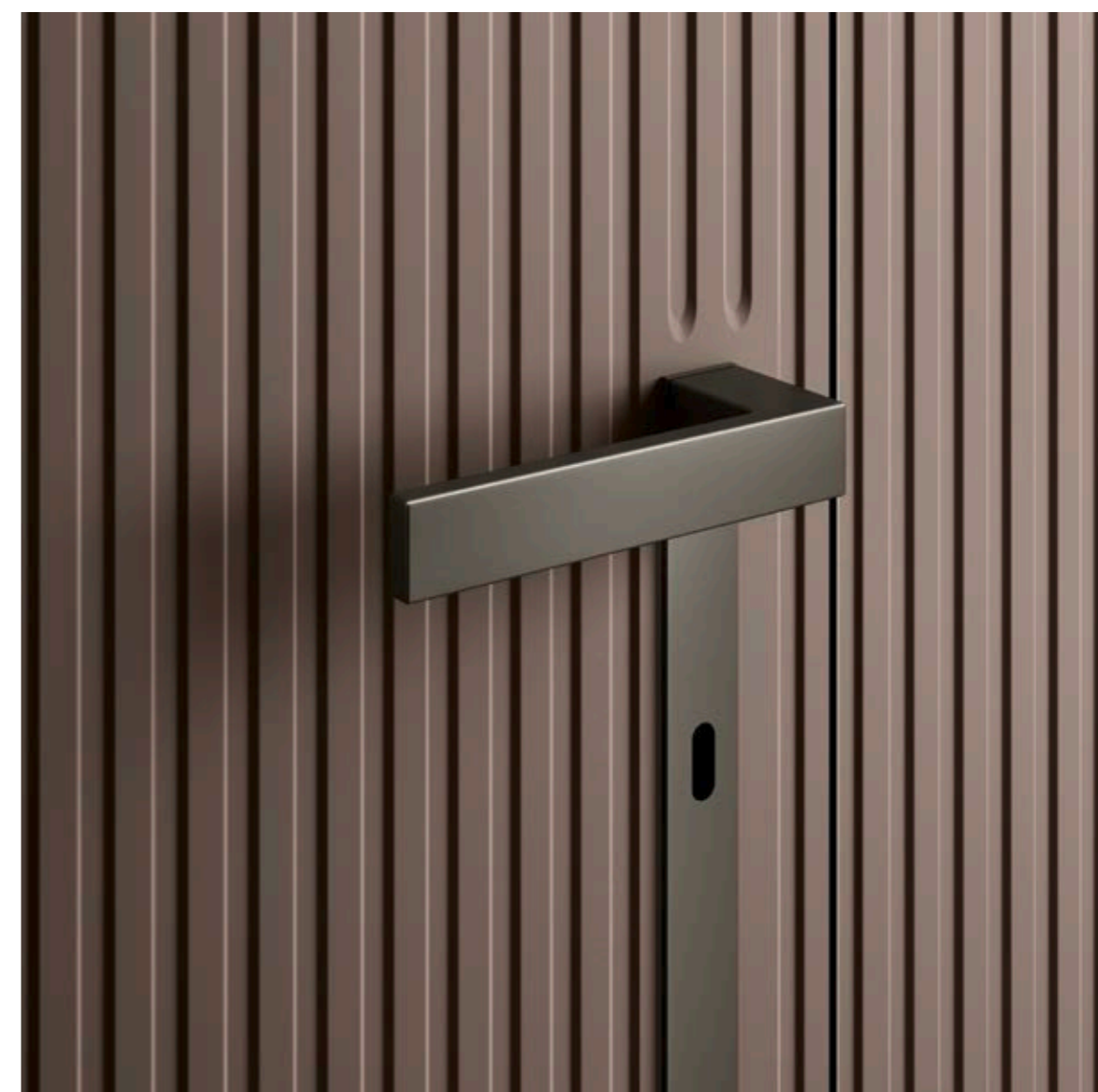



Scorrevole













Cube 6



CUBE 6

Living

CB 001



Classy gentleman

Cube6 in **laccato opaco Nocciola**. Boiserie in **Rovere Carbon 10:2**. Pannello Tv in gres **Noir Desir**.

Cube6 in **Nocciola matt lacquer**. Boiserie **Carbon Oak 10:2**. TV box in **Noir Desir** stoneware.







CB 002



Warm family

Cube6 in **laccato opaco Lino**. Boiserie e Movidia in **Rovere Moka**.

Cube6 in **Lino matt lacquer**. Boiserie and Movidia in **Moka Oak**.







CB 003



Cozy romantic

Cube6 in **Rovere Light**. Boiserie in **laccato opaco Lino 10:10**. Box in **laccato metallico Champagne**.

Cube6 in **Light Oak**. Boiserie in **Lino lacquer 10:10**. Box in **Champagne metallic lacquer**.







CB 004



Warm family

Cube6 retroilluminato in **laccato opaco Nocciola 10:10**. Box a giorno in **Rovere Moka**.

Cube6 backlit in **Nocciola lacquer 10:10**. Box in **Moka Oak**.







CB 005



Warm family

Cube 6 orizzontali in **laccato opaco Canapa**. Cube 6 verticali in **laccato metallico Bronzo**.
Horizontal Cube 6 in **Canapa matt lacquer**. Vertical Cube 6 in **Bronze metallic lacquer**.





CB 006



Classy gentleman

Cube 6 orizzontali in **laccato opaco Vischio 10:10**. Cube 6 superiori con anta vasistas in **vetro trasparente Fumè**.
Horizontal Cube 6 in **Vischio matt lacquer 10:10**. Cube 6 with flap-up door in **smoked transparent glass**.



Complementi giorno

Day complements



Movida

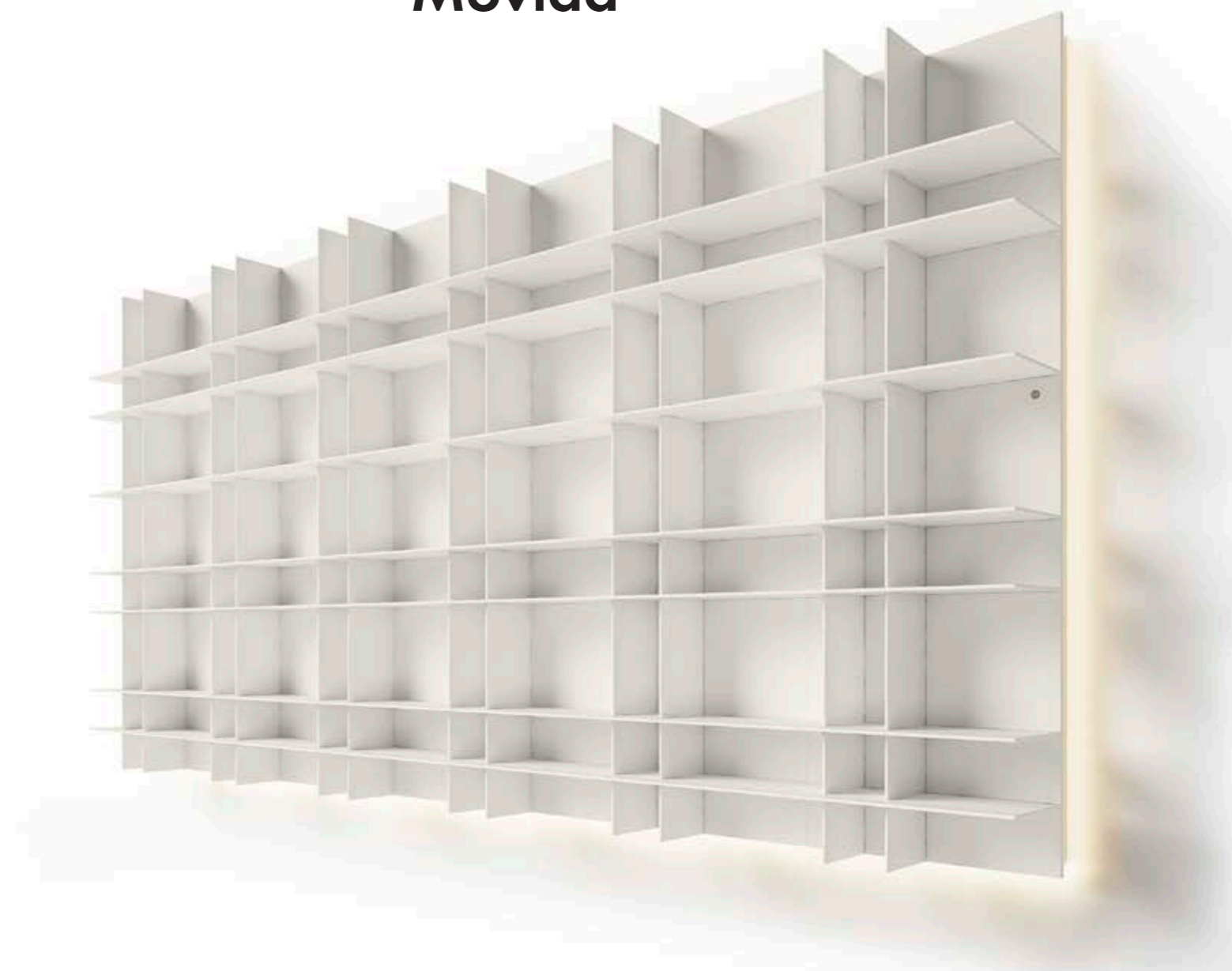

Spessori sottili e diverse profondità rendono questa collezione elegante e raffinata.

Thin thicknesses and different depths make this collection elegant and at the same time refined.









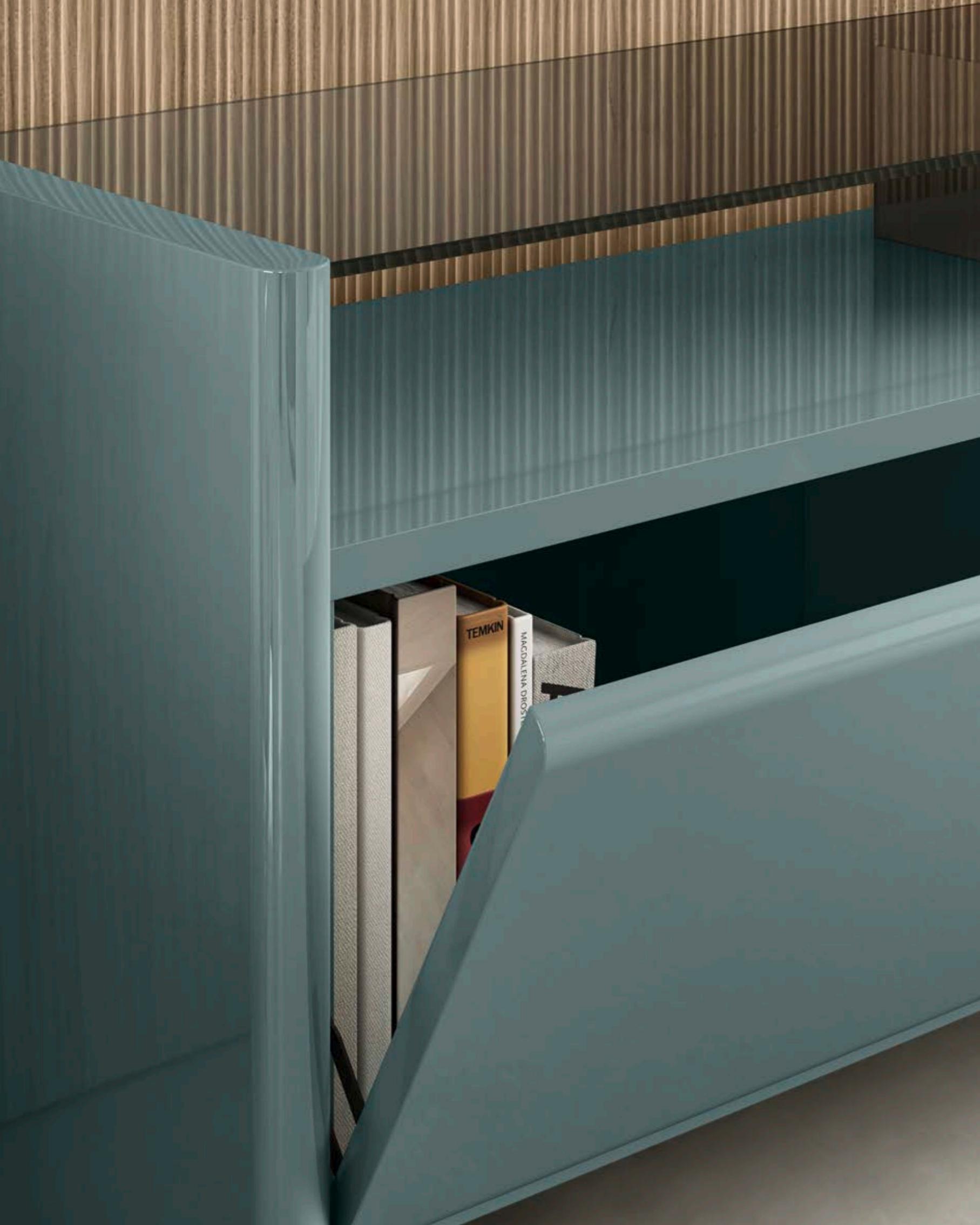

Cosmo

Un richiamo agli anni '80.
Cosmo vuole essere un elemento di rottura
rispetto alle nostre collezioni, ma al tempo stesso
in perfetta armonia nei nostri ambienti.

*A reference to the '80s.
Cosmo wants to be a breaking item
compared to our collections, but at the same time
in perfect harmony in our environments.*

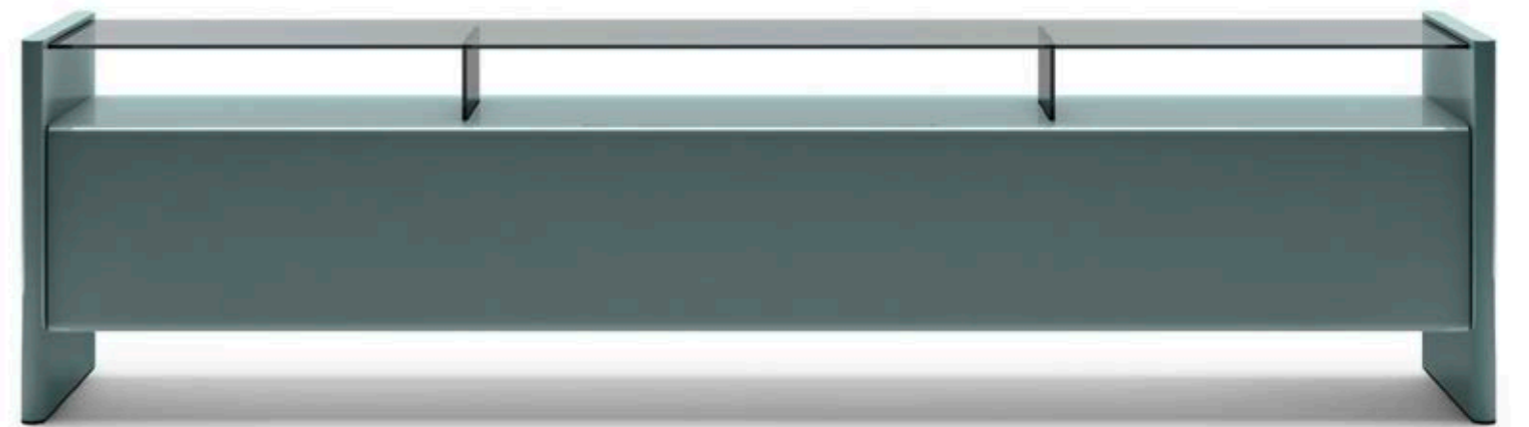











Cosmo Living

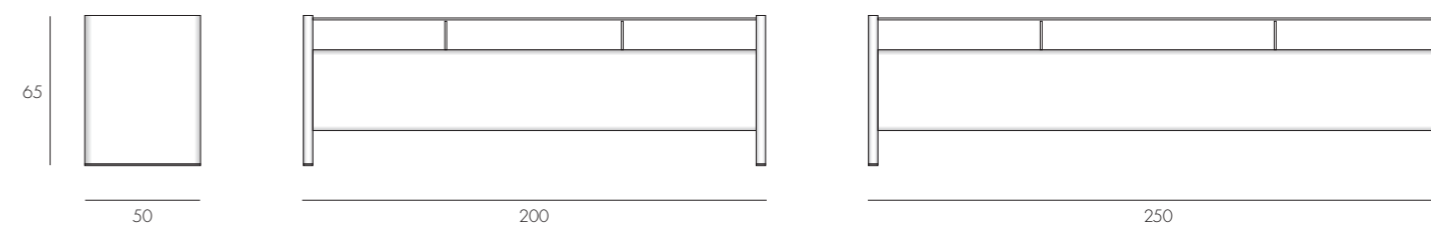

Cosmo Dining

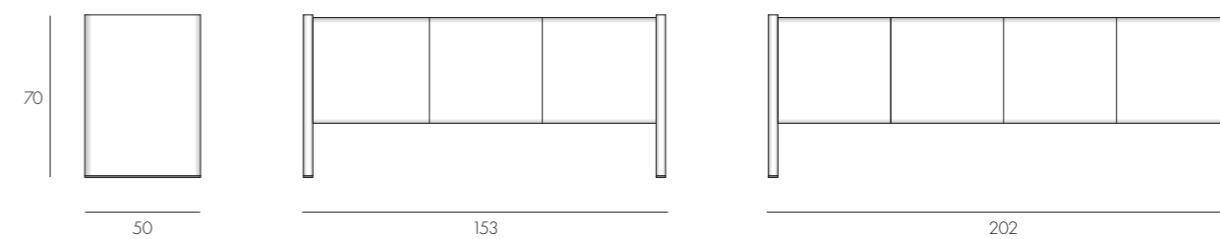

Cosmo Bar

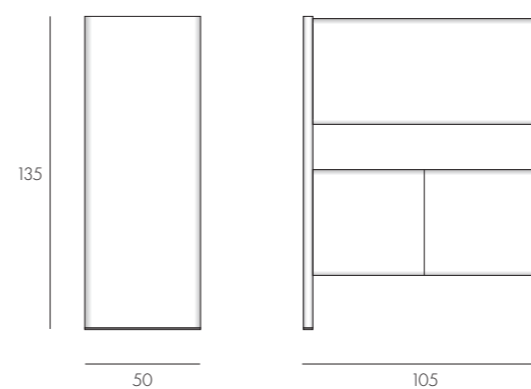



Aqua

Elegante ed altamente personalizzabile.
La madia Aqua si allinea alle finiture del resto del living.

*Elegant and highly customizable.
The Aqua sideboard aligns with the finishes
of the rest of the living room.*











Aqua 177

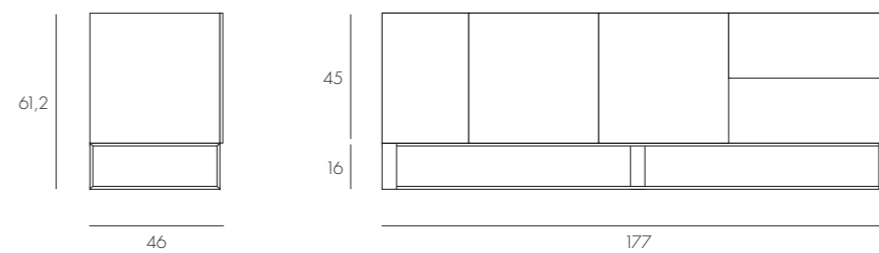

Aqua 133

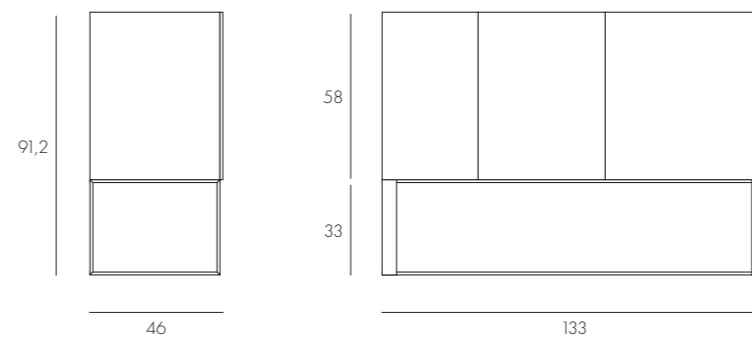

Aqua 90 / Aqua 90 Bar

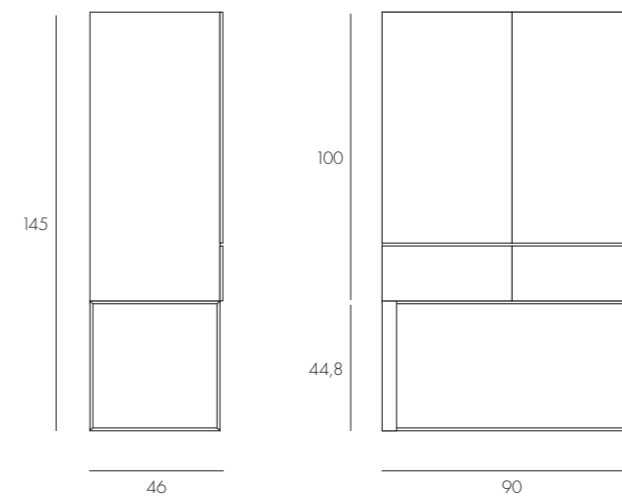



Madia Dress Code

Un progetto nato dall'esigenza di trasmettere
in un unico prodotto i valori del su misura
abbinati alle finiture personalizzabili.

*A project born from the need to convey
in a single product the values of tailor-made
combined with customizable finishes.*

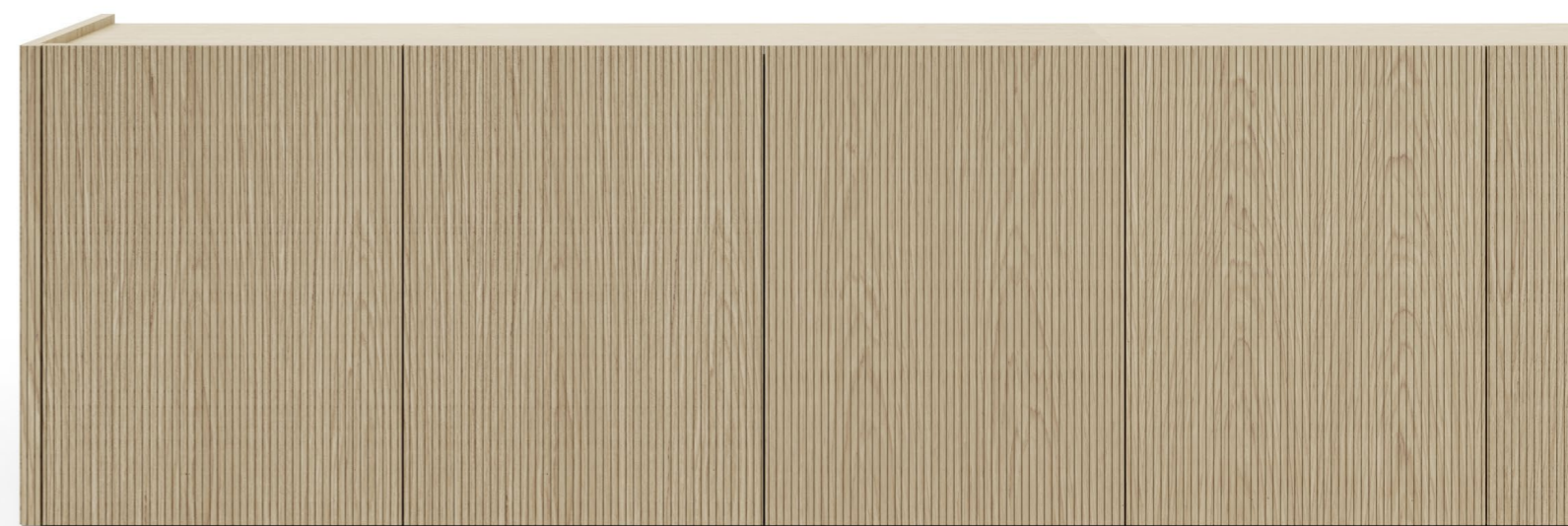



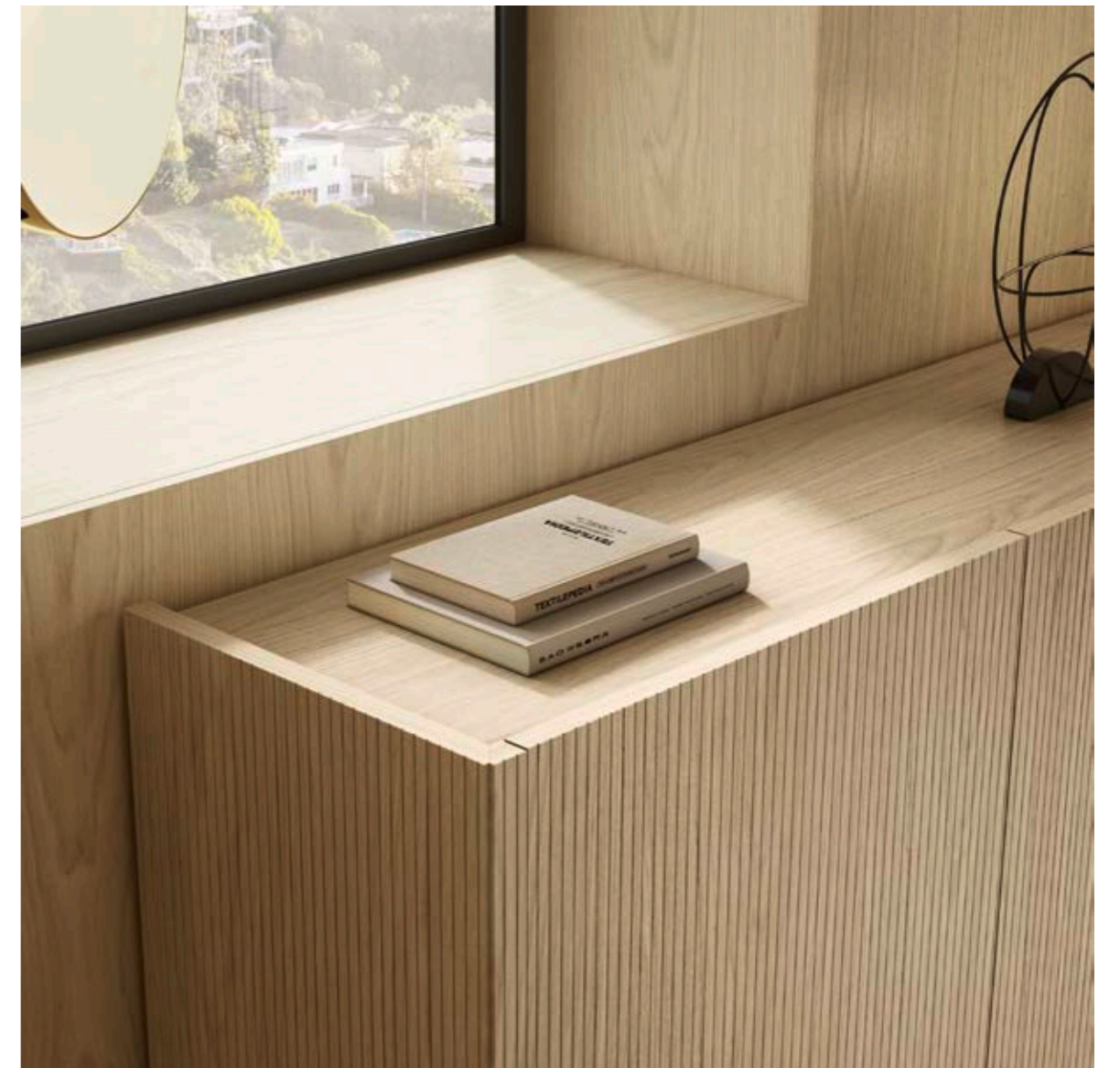







Mr. Big

Imponente ma dolce nelle sue linee morbide.
Il tavolo Mr.Big si distingue per la sua qualità e cura dei dettagli.

*Massive but sweet in its soft lines. The Mr. Big table stands out
for its quality and attention to details.*









Mr. Big rettangolare
Mr. Big rectangular

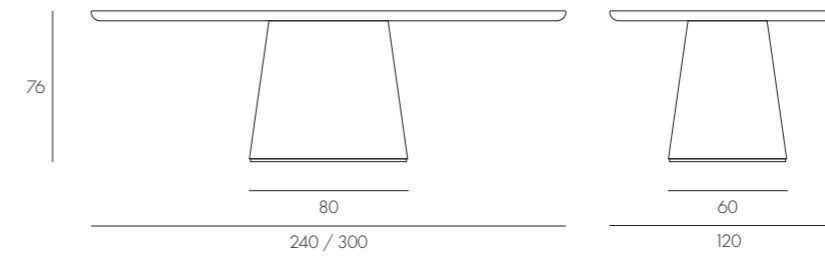
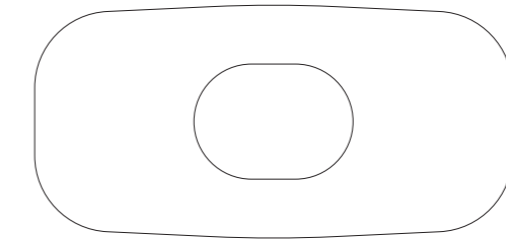

Mr. Big tondo
Mr. Big round

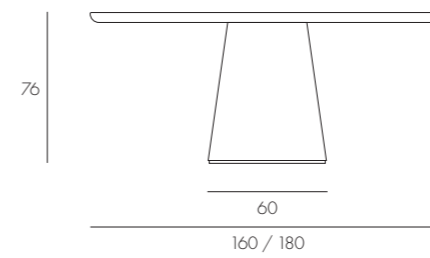
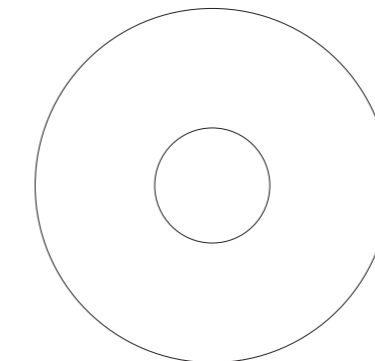

Mr. Big quadrato stondato
Mr. Big rounded square

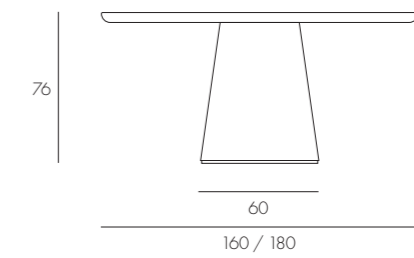
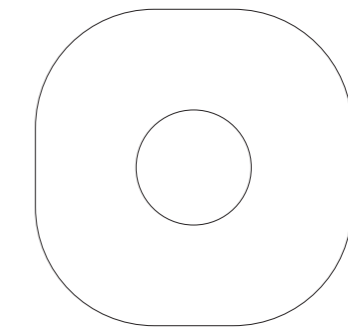



Hector

Dal design deciso e rigoroso, Hector è il protagonista perfetto per gli ambienti sofisticati.

With a straight and rigorous design, Hector is the perfect main actor for sophisticated environments.







Tavolo Hector
Hector table

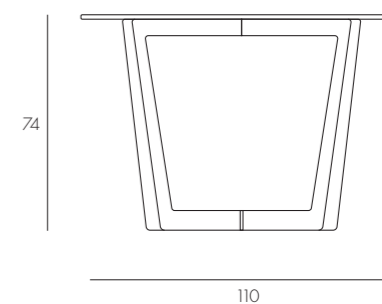
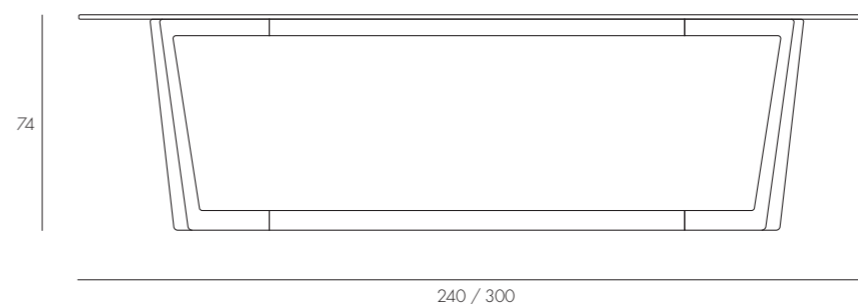
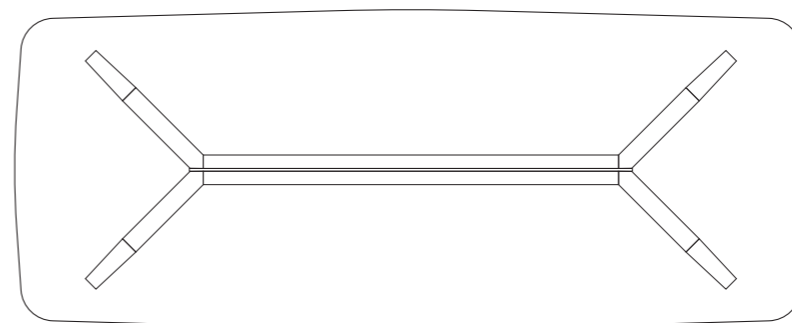



Ambrogio

La classe di questo tavolo, unita alla facilità di utilizzo del sistema allungabile ne fanno un oggetto di grande personalità.

The elegance of this table, combined with the easy extendable system, makes it an object of great personality.







Tavolo Ambrogio
Ambrogio table

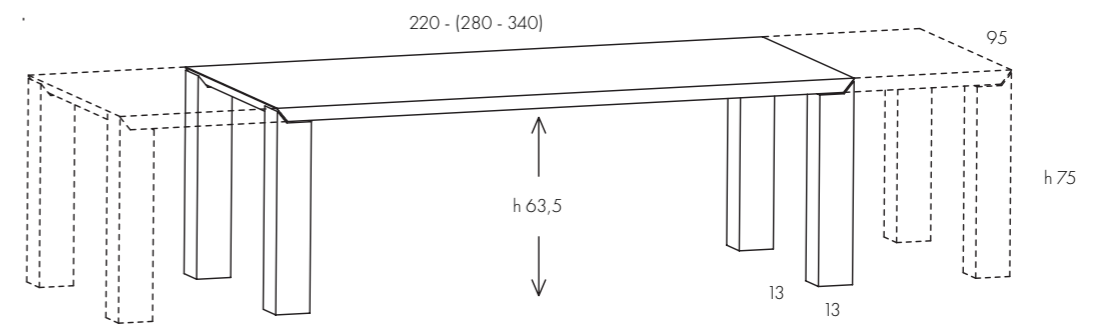
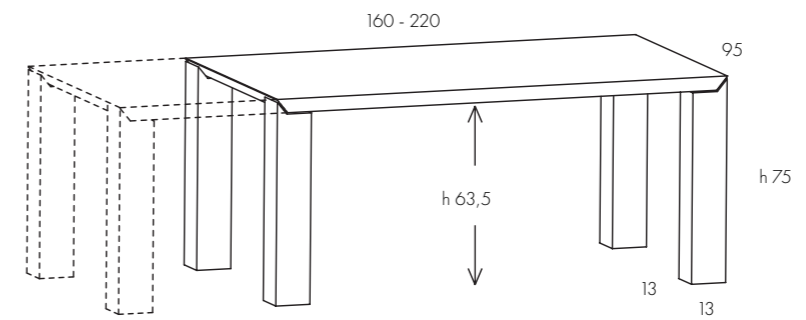



Adam

Le forme morbide, unite all'abbinamento legno-pelle o legno-tessuto rendono Adam la sedia ideale per tutti gli arredi borghesi.

The soft shapes, combined with the combination of wood-leather or wood-fabric, make Adam the ideal chair for all bourgeois environments.





Sedia Adam
Adam chair

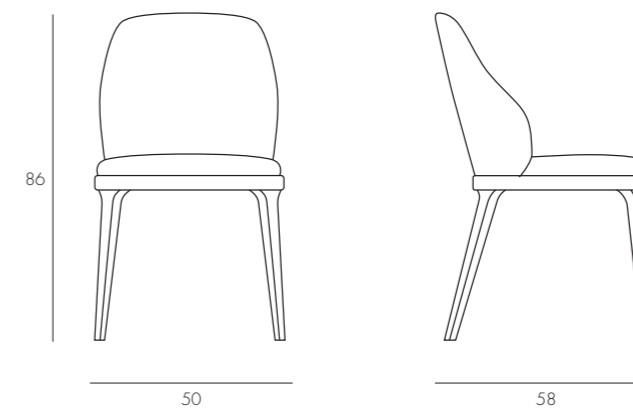

Poltroncina Adam
Adam armchair

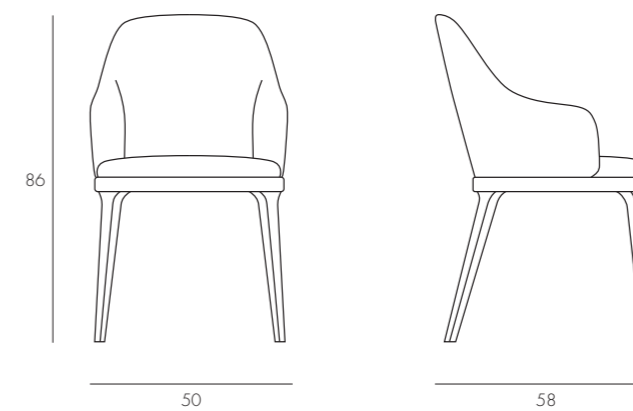

Project

MICHELE SARTINI

Project Assistant

ALESSIA TACCONI

Art Direction

LUALDI MERALDI STUDIO

Graphic Design

OFFICINE BONFIGLIOLI

3D Rendering

ARCHÈ AGENCY

Fotolito

LIFEINPIXEL

Stampa

LA PIEVE POLIGRAFICA

